

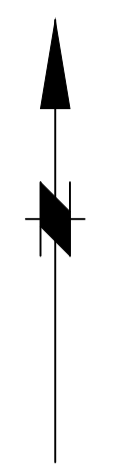

This map is reproduced from Ordnance Survey material with the permission of Ordnance Survey on behalf of the Controller of Her Majesty's Stationery Office. © Crown copyright. Unauthorised reproduction infringes Crown copyright and may lead to prosecution or civil proceedings. Stockport Metropolitan Borough Council 100019571 2012

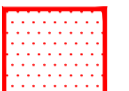

-  LAND REQUIRED FOR THE SCHEME (PERMANENT)
-  LAND REQUIRED FOR THE SCHEME (TEMPORARY) MATERIAL STORAGE/COMPOUNDS/WORKING SPACE ETC
-  LAND REQUIRED FOR THE SCHEME (EASEMENT)
-  EXISTING LOCAL AUTHORITY LAND REQUIRED FOR THE SCHEME

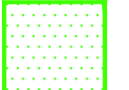

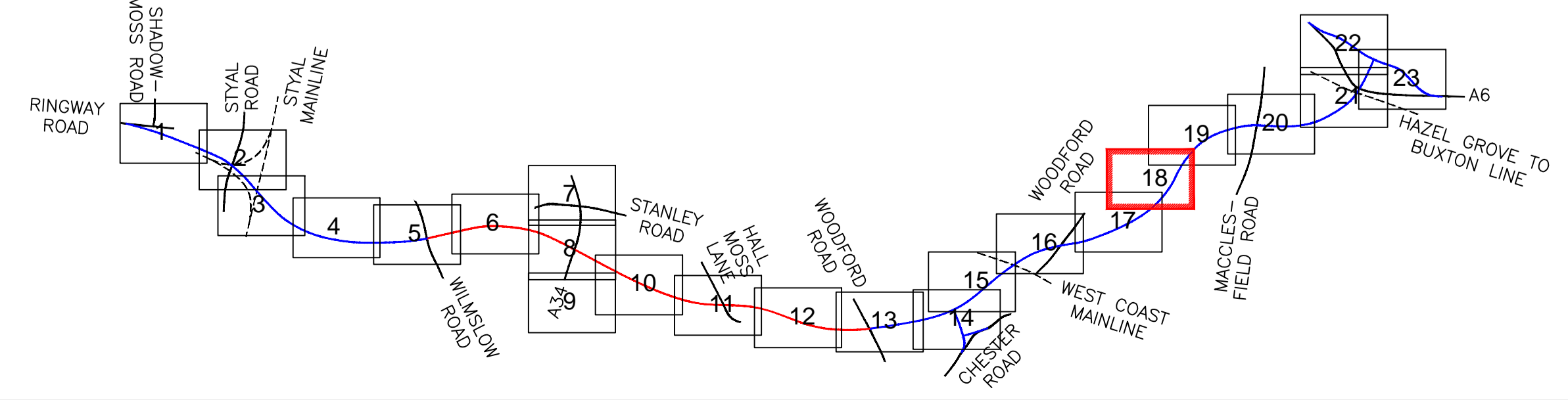
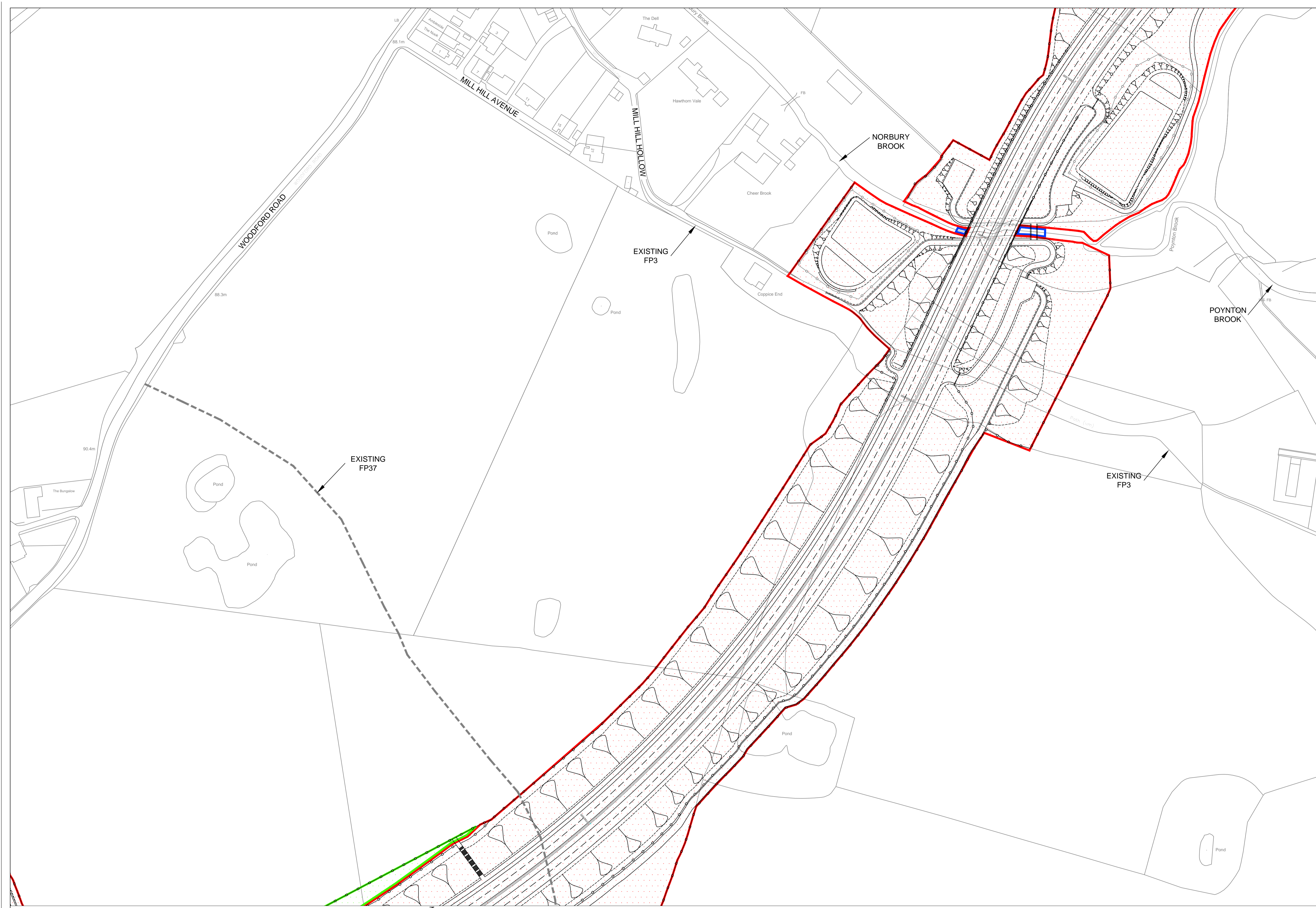
Rev.	Drawn	Checked	Date	Revision Details

[www.semmms.info](http://www.semmms.info)

STOPFORD HOUSE  
STOCKPORT SK9 3YE  
TEL : 0161 474 4351  
FAX : 0161 474 4633

Job Title  
**A6 - MANCHESTER AIRPORT RELIEF ROAD**

Drawing Title  
**PLANNING APPLICATION BLOCK PLAN EXISTING SHEET 18**

Drawn SEB/DP	Engineer SP	Checked NH	Approved AB
Date 03.10.13	Date 03.10.13	Date 03.10.13	Date 03.10.13
Size A1	Scale 1:1000		
SCG No.	Filename		
Drawing No. 1007/3D/DF7/A6-MA/PABP/E/017	Revision		